

VIN:	XXXXXXX	Vehicle:	MINI/F56/HAT/Cooper/B38/AUTO/USA/LL/2014/11
System Version:	3.47.10.13054	Data Version:	R3.47.10.13054

51 16 366

Removing and installing/replacing right glove box with housing



When working on trim panel components, make sure that visible surfaces are not scratched or damaged (e.g. by sharp-edged tools).



- Necessary preliminary tasks:
- Remove [side panel on instrument panel on right](#)



REMOVAL:

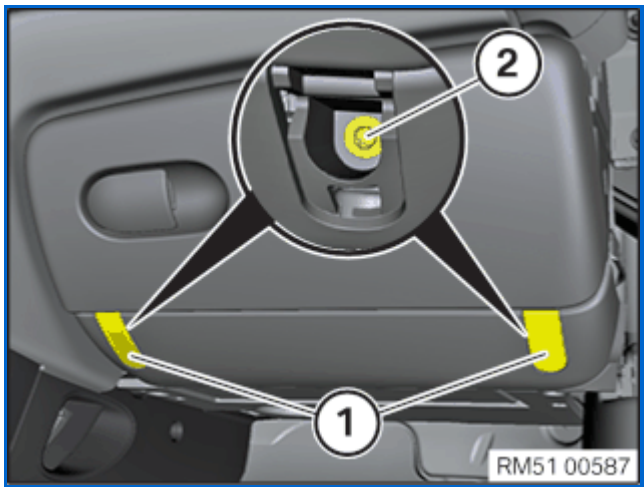

Lever out covers (1) and release screws (2) underneath.

Release screws (1).

Remove glove box (2) inwards and disconnect associated plug connections.

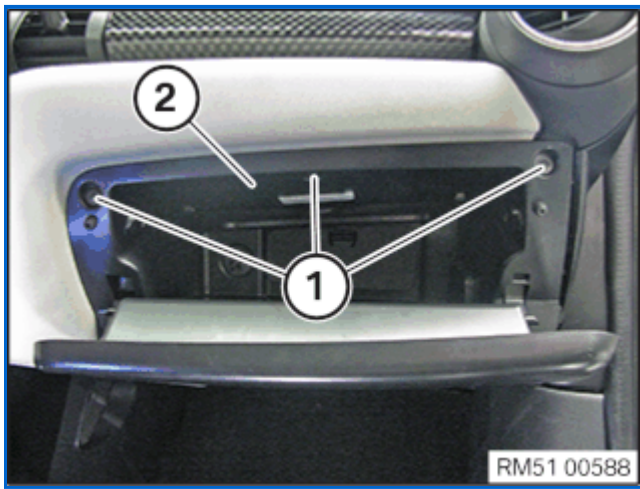

INSTALLATION:



When replacing, swap over the following parts:

- [Glove box damper](#)
- [Glove box lid](#)
- [Glovebox light](#)

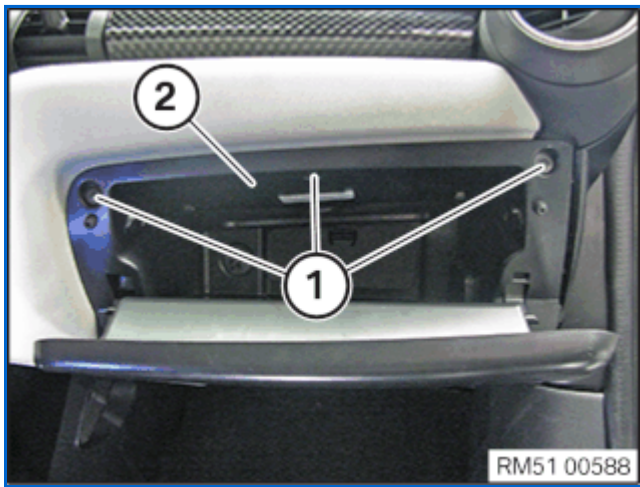

Connect associated connector and connect air hose if required.
Insert glove box (2) and secure with screws (1).

Tighten down screws (2).
Clip in covers (1).

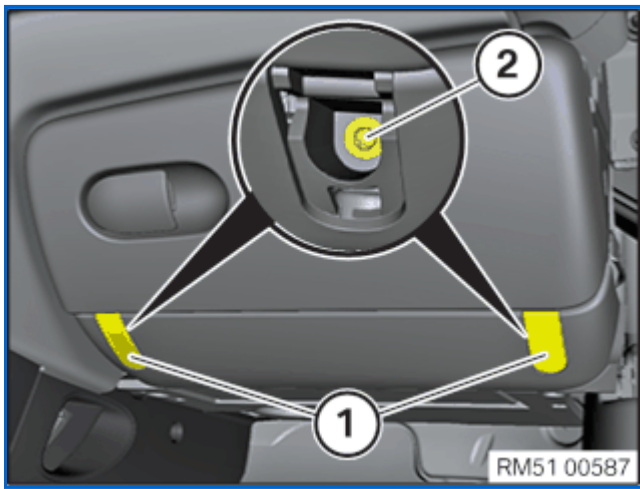

Required follow-up work:

- Install [side panel on instrument panel, right](#)